

3/1/17

SA 5B



**11 Valley Road
Welwyn Garden City
Herts
AL8 7DG**

21 October 2016,

Dear Sir/madam,

Application reference: 6/2016/1523/EM

I am writing to appeal the decision to refuse my application for the formation of a new driveway at the above address. I understand from talking to the planning department that the reason for the refusal was that the new plans included a 60/40 split between soft and hard landscaping. Consequently I have amended the plans and please find enclosed a new plan that represents a 50/50 split. To facilitate access onto the driveway and I am also applying to trim a small portion off the end of the front hedge which would be the minimum required to access the hard standing. The vast majority of the original hedge would remain in place.

As I said in the initial application I am also applying to remove a conifer and replace it with a silver birch.

I hope that the amendments will better meet the requirements of the Estate Management Consent scheme and that you will be able to accept my appeal and allow my application.

If you require any further information, you can contact me at at the above address or my phone number is 07718512423.

Yours faithfully,

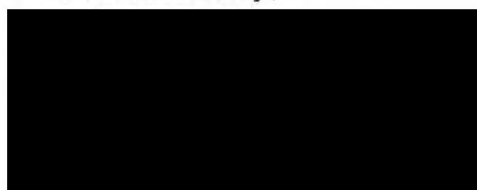

Emma Luck
encs.

EXISTING DRIVE PLAN

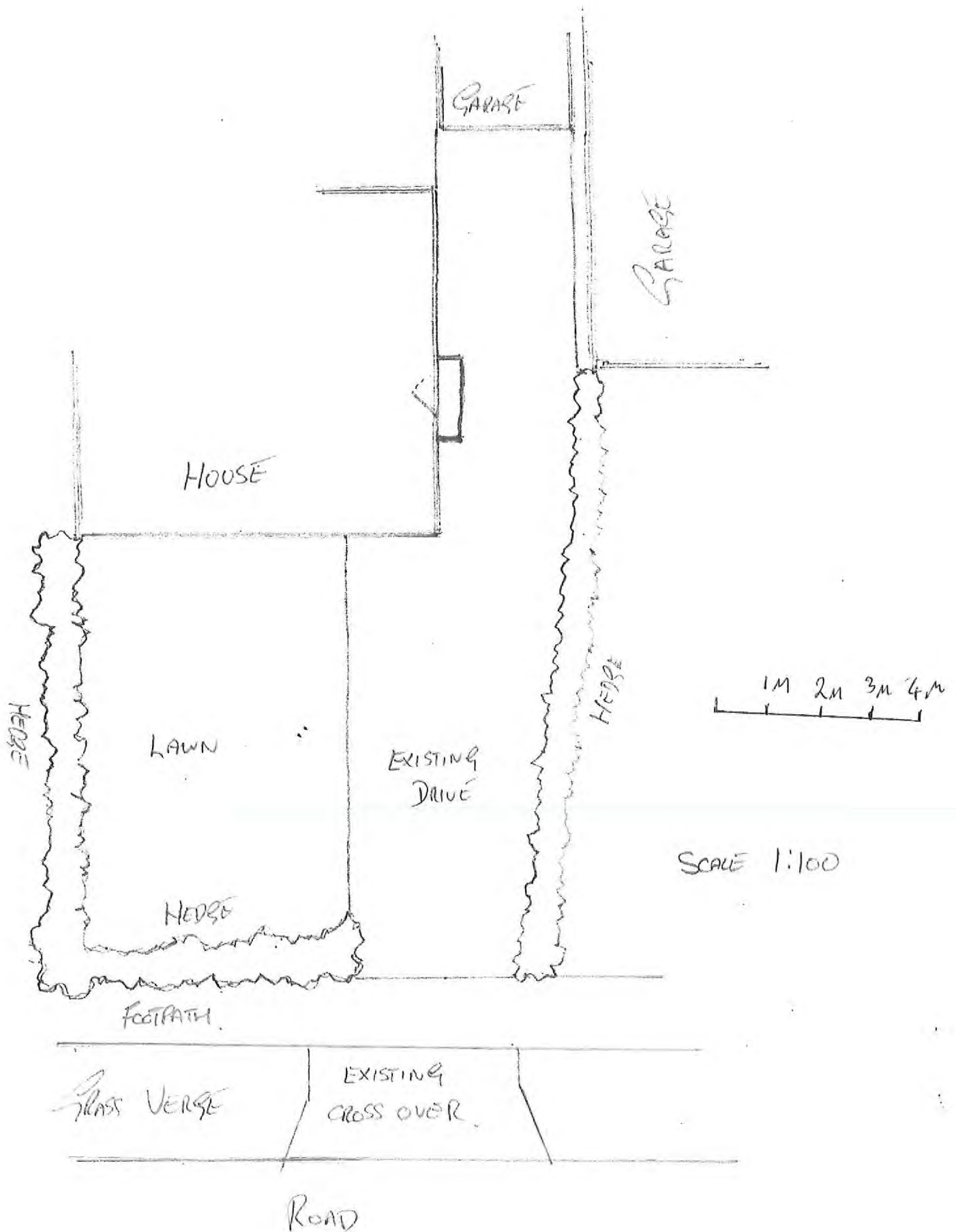

NEW DRIVE PLAN

